



jordan fishwick

BURNAGE
Lomas Close



Lomas Close, Burnage, M19 1TE

£160,000



The Property

**** 70% EQUITY & 55 YEARS OR ABOVE**** - An appealing, two bedroom bungalow forming part of a quiet purpose built residential development on the borders of Heaton Mersey, Burnage and Didsbury. The well planned living space benefits of both gas fired central heating and uPVC double glazing and in outline comprises:- Entrance lobby with cloaks cupboard. living room, fitted kitchen, two bedrooms and tiled shower room. Externally, there is an attractive garden to front and rear of property.

The property is being sold in conjunction with Johnnie Johnson Housing Association and purchasers will be buying 70% equity, with no rent payable on the remaining 30%. A monthly service charge (currently £105.58pcm) is payable & covers the buildings insurance & exterior of the building.

Directions

M19 1TE

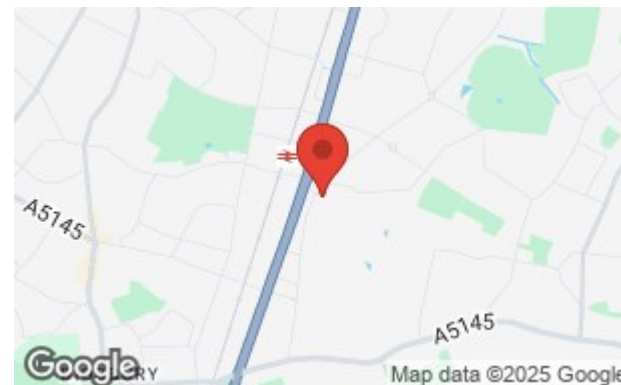

- 70% equity
- 55 years and above
- Sought after development
- Appealing bungalow
- Two bedrooms
- Fitted kitchen & shower room
- Generous living room
- Gas central heating & double glazing
- Attractive gardens
- No onward chain

Postcode - M19 1TE

EPC Rating - C

Floor Area - 519.00 sq ft

Local Authority - Manchester City Council

Council Tax - C



GROUND FLOOR
519 sq.ft. (48.2 sq.m.) approx.

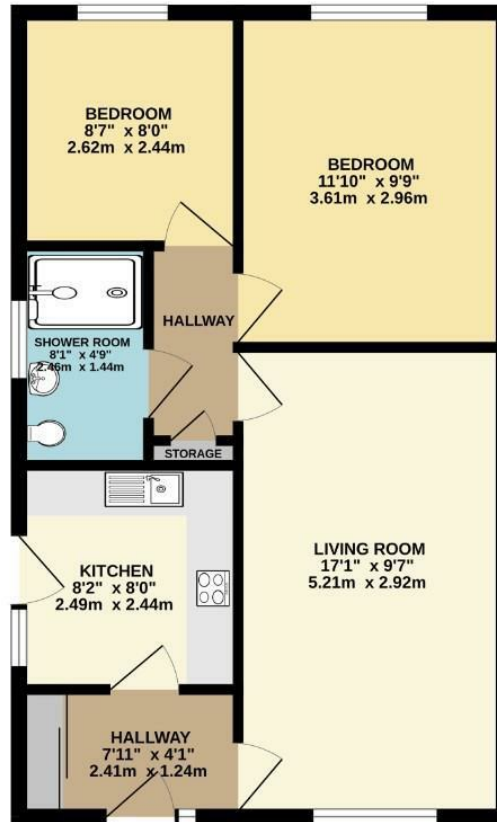

TOTAL FLOOR AREA: 519 sq.ft. (48.2 sq.m.) approx.
Measurements are approximate. Not to scale. Illustrative purposes only.
Made with Metropix ©2024



These particulars are believed to be accurate but they are not guaranteed and do not form a contract. Neither Jordan Fishwick nor the vendor or lessor accept any responsibility in respect of these particulars, which are not intended to be statements or representations of fact and any intending purchaser or lessee must satisfy himself by inspection or otherwise as to the correctness of each of the statements contained in these particulars. Any floorplans on this brochure are for illustrative purposes only and are not necessarily to scale.

Offices also at: Wilmslow, Macclesfield, Hale, Sale, Chorlton, Glossop, Manchester & Salford

757-759 Wilmslow Road, Didsbury Village, Manchester

0161 445 4480

didsbury@jordanfishwick.co.uk
www.jordanfishwick.co.uk